

# Golden Goal 44 Jr. Club-PB

Official Size: 6.5'H x 18.5'W x 4' T x 6.5'B

4"x4" Square Ext. Alum. w/ .75 Radius Corners For Safety  
 Reinforced Corners For Extra Durability  
 Transport Wheels, Net & Rear Tie Downs Included  
 Uprights, Crossbar & Backstay Powder Coated White

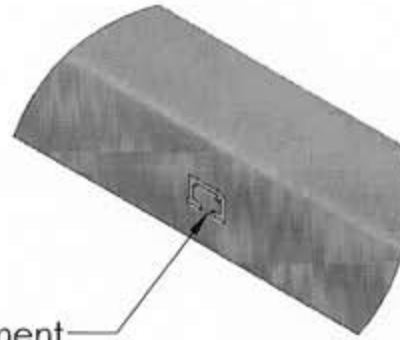

Exclusive "Stay-Put" Net Attachment

DETAIL A  
 SCALE 20 : 105

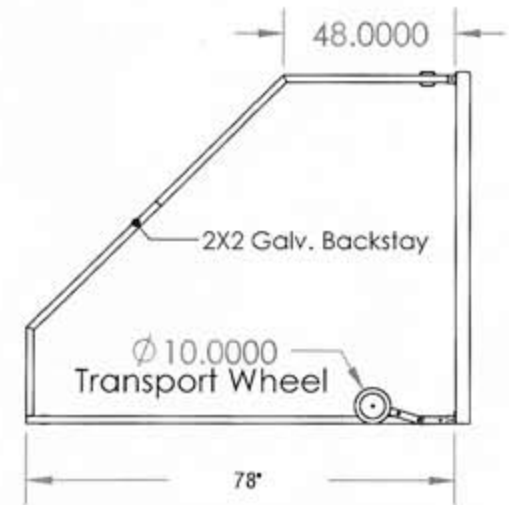
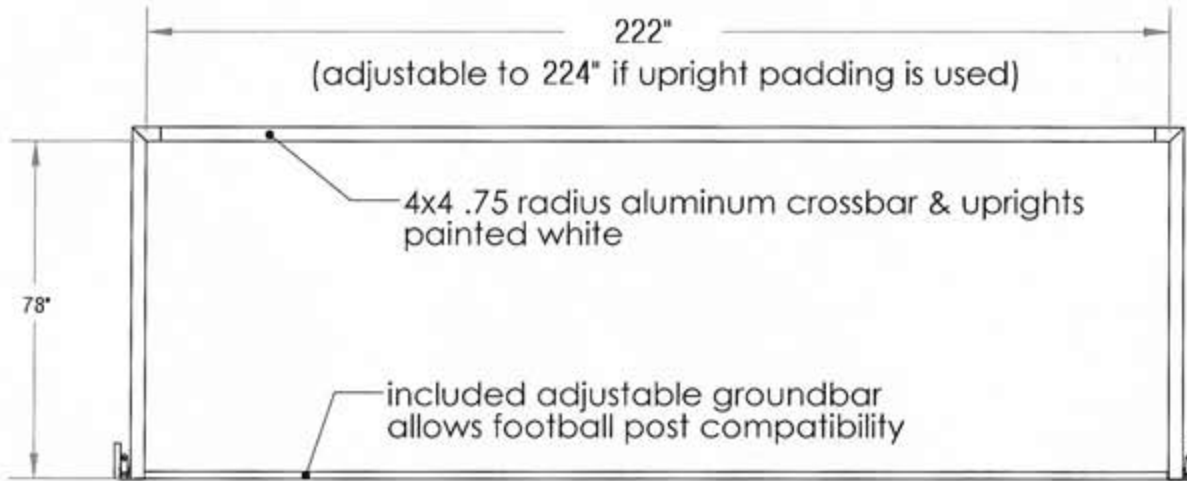
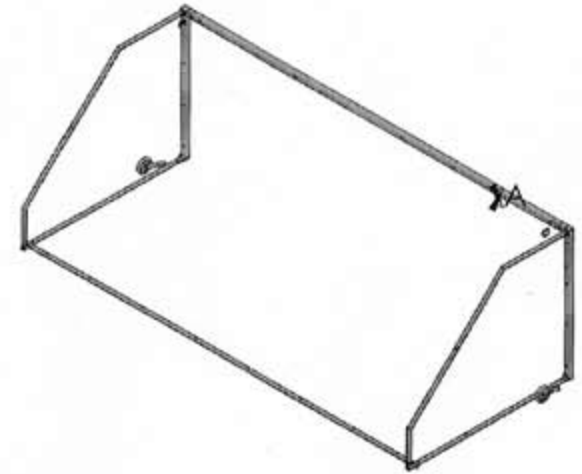

**PROPRIETARY AND CONFIDENTIAL**  
 THE INFORMATION CONTAINED IN THIS DRAWING IS THE SOLE PROPERTY OF FIRST TEAM SPORTS, INC. ANY REPRODUCTION IN PART OR AS A WHOLE WITHOUT THE WRITTEN PERMISSION OF FIRST TEAM SPORTS, INC. IS PROHIBITED.

		UNLESS OTHERWISE SPECIFIED:	NAME	DATE
		DIMENSIONS ARE IN INCHES	DRAWN	JLR
		TOLERANCES:	CHECKED	
		FRACTIONAL ±	ENG APPR.	
		ANGULAR: MACH ± BEND ±	MFG APPR.	
		TWO PLACE DECIMAL ±	Q.A.	
		THREE PLACE DECIMAL ±	COMMENTS:	
		INTERPRET GEOMETRIC TOLERANCING PER:		
		MATERIAL		
		Aluminum/Steel		
		FINISH		
NEXT ASSY.	USED ON			
APPLICATION		DO NOT SCALE DRAWING		

TITLE:  
**First Team Sports, Inc.**

SIZE	DWG. NO.	REV
<b>A</b>		
SCALE: 1:55	WEIGHT	SHEET 1 OF 1